

Updated Plan

- BGP** Break glass point (By tenant)
- HD** Heat detector (By tenant)
- SD** Smoke detector, with built in sounder (By tenant)
- FP** Fire panel (By tenant)
- EL** Emergency light with built in running man (By tenant)

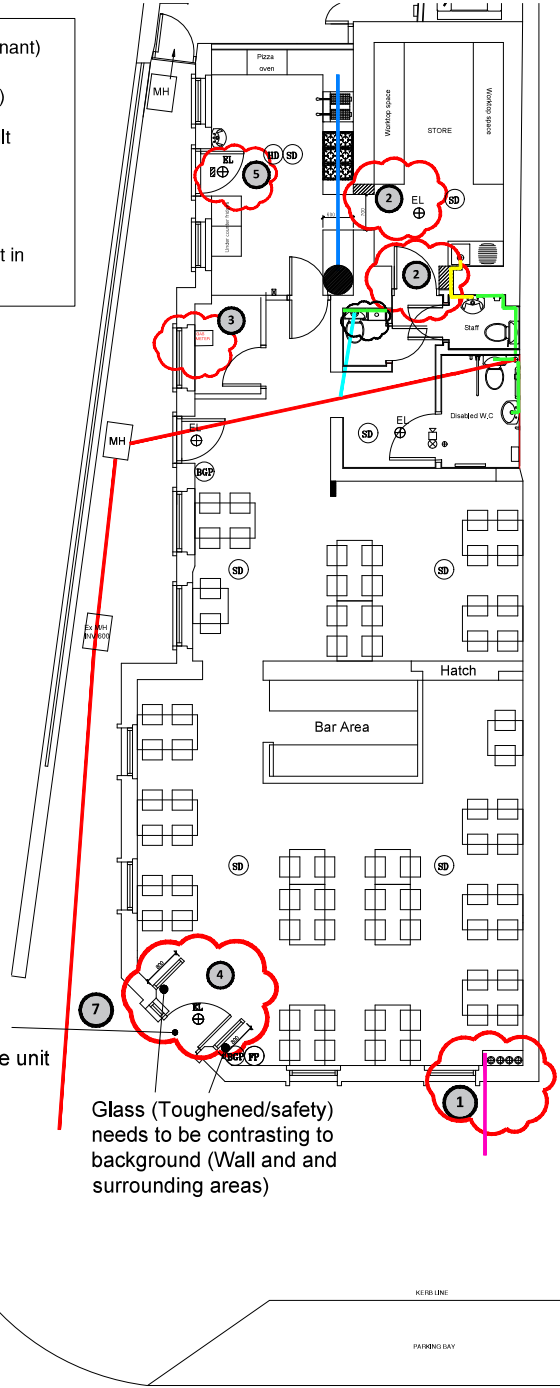

- Note: All internal walls and finishes by Tenant
- 1** Full height boxing for water services and broadband by Tenant
- 2** New studwork to areas (All by Tenant)
- 3** New internal gas meter (By landlord)
Boxing out of meter (By tenant)
- 4** New glass panels to entrance area (By tenant)
- 5** New vent in top of door (By tenant)
- 6** New sinks to be installed (By tenant)
- 7** Temporary ramp system to negotiate step to unit (By tenant)
- Proposed rodding position by WC drain (By tenant)
- New overhead extract run for cooking equipment (By tenant)
- Proposed position for flue through roof (By tenant)
- Above Ground drainage (By tenant)
- New below Ground drainage connection (By contractor)
- Below Ground drainage (Existing)
- Proposed sink connection (By tenant)
- Incoming broadband through wall and positioned in cupboard (By others)

Door colours to be contrasting to background walls. Ironmongery on said doors to be a contrasting colour to background walls and doors.

- Two lobby doors
- DDA toilet door
- Staff and gender neutral toilet door

(By tenant)

Extracts in W.C.s all linked to one with a single exit point extract to side of building to open air. (Contractor to create external opening and provide grill. (Internal extracts by tenant)

Temporary ramp system required for the public to negotiate the step into the unit

Glass (Toughened/safety) needs to be contrasting to background (Wall and surrounding areas)

B 17.10.2023 External seating area to side of building omitted A 09.06.2023 Building control plan combined with landlord tenant plan Rev: Date: Description:	MAC Drawn: Checked:
Project/Client: 35 Church Road	Drawn By: Date: Checked By: MAC 04.05.2023
Drawing: Proposed ground floor	Scale: Drawing No: Revision: 1:100@A3 FP371 B
Project No: 1859	

CPLC
 ASSOCIATES
 The Bungalow, 87a Station Road
 Bishops Cleeve, Cheltenham, GL52 8HJ.
 Telephone : 01242 672 333
 cplc@cplc-associates.com

©CPLC Associates Ltd, Contractors must work to figured dimensions which are to be checked on site, Any discrepancies must be reported immediately.