

KEY



Mature vegetation to be retained.



Existing stone hard standing.

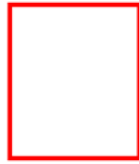

Application Site



Application Reference 20/00341/AGR

General purpose agricultural building

Land adjacent to Stump Lane

Hucclecote

Gloucester

Gloucestershire

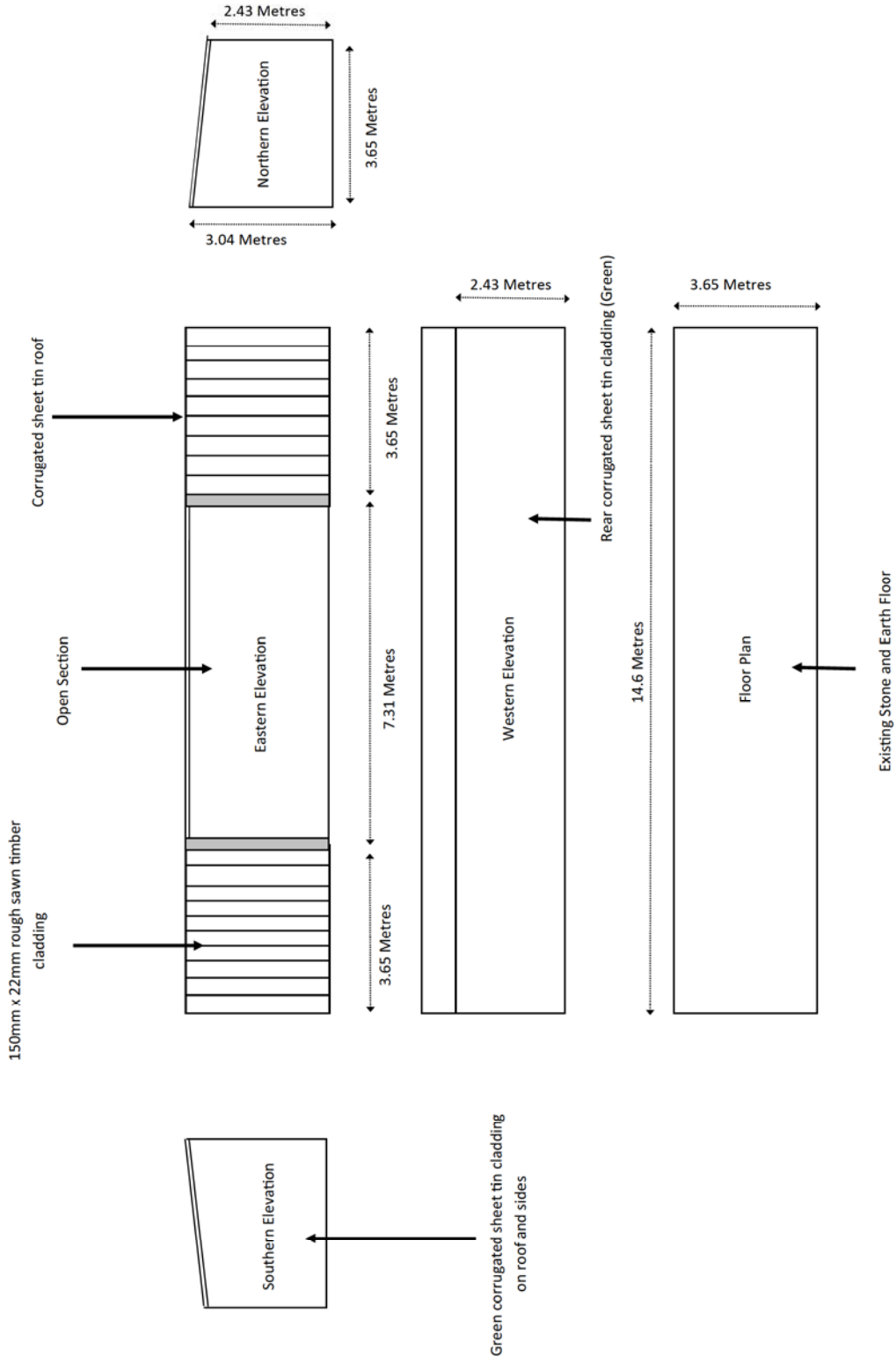

Proposed New General Purpose Agricultural Building | Land off Stump Lane, Churchdown, Gloucestershire

Materials Plan

Scale: 1: 200 @ A3